

Car	BMW M240i GPF Models	Part No.	SBMS101CF
Year	2018-2019	Fit Kits	363FK
Notes	Where not supplied use original fittings. Original system requires cutting.	Features	Pipe Diameter:- 80mm

Estimated Fitting Time: 1 Hour 30 Minutes

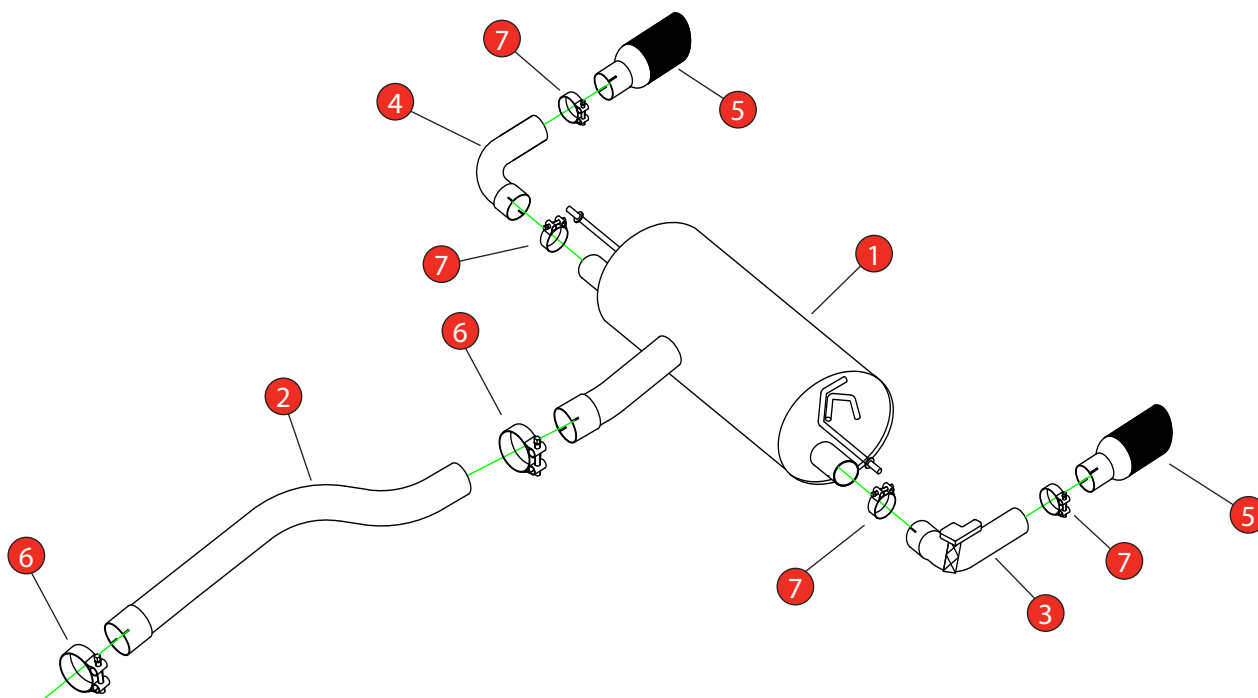

NO.	PART NO.	DESCRIPTION	QTY
1	730BM	Rear Silencer	1
2	809BM	Link Pipe	1
3	731BM	L/H Trim Connecting Pipe With Valve	1
4	732BM	R/H Trim Connecting Pipe	1
5	Z023.10158	Carbon Fibre Ascari Trim	2
Fit Kit: 363FK			
6	Z016.10069	79 - 85mm Clamp	2
7	Z016.10064	63 - 68mm H/D Clamp	4

DATE	16/02/24
ISSUE	00
AUTHORISED	G. O'Shea

NOTE: ENSURE SCORPION SYSTEM IS CLEAR OF MOVING PARTS AND ALL ORIGINAL FUNCTIONS WORK CORRECTLY.



STAY CONNECTED TO RED POWER.

Car	BMW M240i GPF Model	Part No.	SBMS101CF
Year	2018-2019	Fit Kits	363FK
Notes		Features	Pipe Diameter:- 80mm

Estimated Fitting Time: 1 Hour 30 Minutes



A) Remove the electronic actuator from the original exhaust.

B) On the scorpion product fit the fixing bow into the valve and use the actuator to secure the bow in place.

C) Use the M6 bolts and washers to fasten the actuator to the valve ensuring the two straights on the fixing bow fit between the grooves on both of the posts.

